

Silo Ridge Resort Community
Master Development Plan Program Summary

Plan Key	Building Type/Use	Detail	SF	Total SF	Max Height	Ownership	Total Bedrooms	Parking	Notes
C	Condo Hotel	300 Units	385,000	385,000	70	Partial Condominium	463	300	Key count includes 83 lockout rooms
	Restaurant and Lounge Cafe	150 seats 30 seats							
B/C	Banquet Conference	300 seats 145 seats						100	Included in Hotel
GC	Golf Clubhouse	1	25,000	25,000	65			108	
	Restaurant Lounge/Bar	80 seats 40 seats							
	Golf Shop	1	1,355	1,355					
SPA	Spa/Fitness/Health & Wellness	1	81,490	81,490	80			157	
R	Retail Space	17	1,100	18,700	NA			24	4,700 of is the average
S	Single Family	41	4,700	192,700	35	Fee Simple	162	82	4,700 of is the average
	3 Bedroom	18	3,000 to 4,400				84		
	4 Bedroom	17	3,500 to 5,400				98		
	5 Bedroom	6	6,000				30		
G	Golf Villas	19	3,100	58,900	35	Fee Simple	83	38	3,100 of is the average
	3 Bedroom	13	3,000 to 3,200				39		
	4 Bedroom	6	3,200 to 3,300				24		
T	Townhomes	146	2,400	350,400	48	Condominium	438	282	2,400 of is the average
	3 Bedroom		2,000 to 2,700						
F	Flats	153	1,600	229,500	55	Condominium	308	230	1,500 of is the average
	2 Bedroom		1,400 to 1,800						
W	Winery Restaurant	80 seats	5,000	5,000	28			30	
M	Maintenance	1	5,000	5,000	28			24	
TE	Tennis	5		18,000				16	
	Indoor	2							
	Outdoor	3							
A	Accessory								
	Welcome House	1	600	600				2	
	Folly	1	600	600				3	
	Cabana	1	600	600				3	
	Townhome Amenities Building	1	1,500	1,500				10	
Grand Total			1,373,645				1,412	1,416	659 Units Hotel and Residential

LEGEND:

- OVERALL PROJECT BOUNDARY
- PROPOSED BUILDINGS
- GARAGE SPACE
- CONDO HOTEL
- FLATS
- TOWNHOMES
- FLATS/RETAIL SPACE
- GOLF VILLAS
- TOWNHOMES/FLATS
- TOWNHOMES/RETAIL SPACE
- SINGLE FAMILY
- GOLF CLUBHOUSE
- WINERY
- TENNIS
- BANQUET/CONFERENCE
- PROPOSED PRIVATE ROAD
- PROPOSED STORMWATER MANAGEMENT BASIN
- PROPOSED GOLF GREEN AND FAIRWAY
- BLOCK REFERENCE FOR PHASING

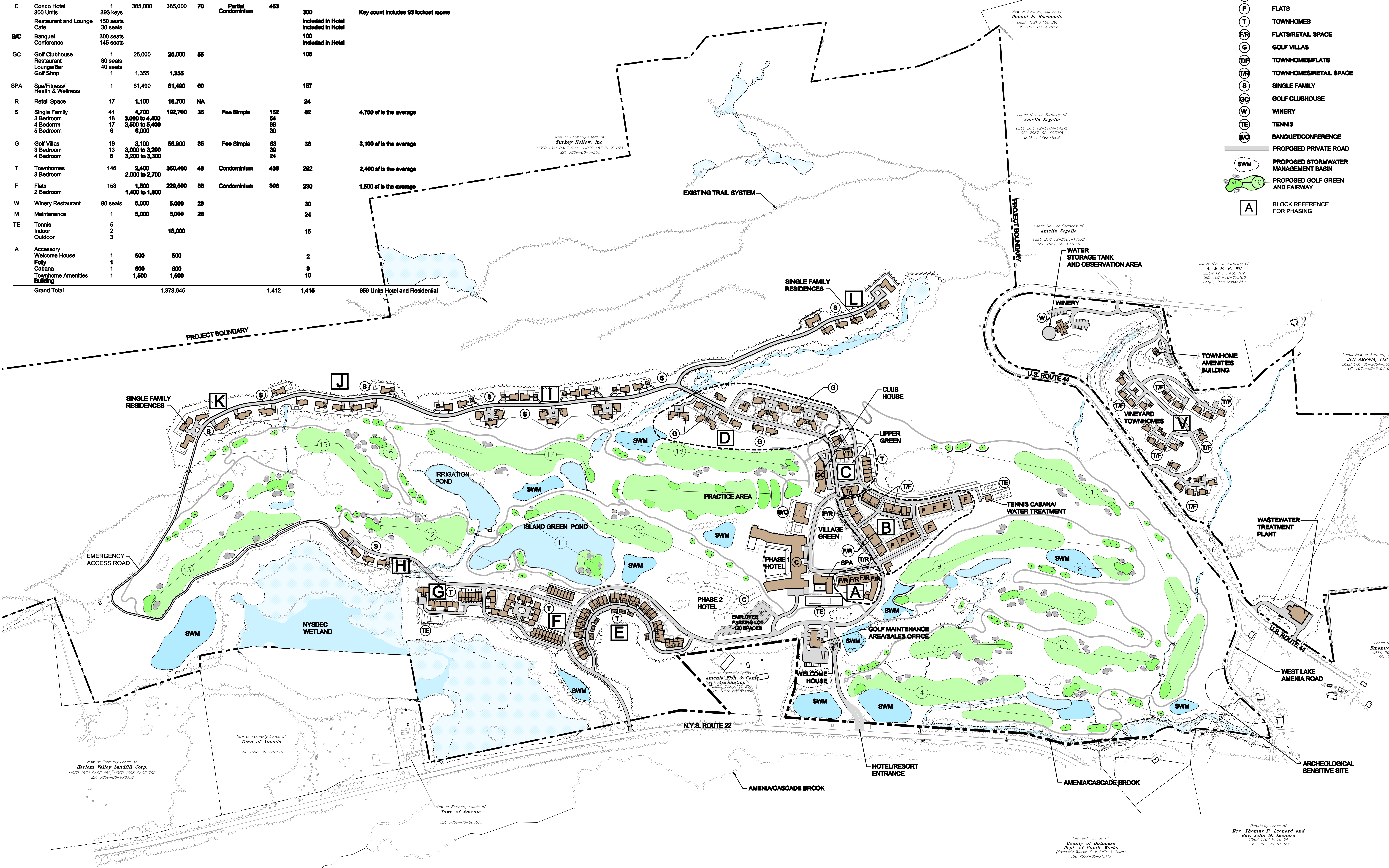

Silo Ridge
Resort Community

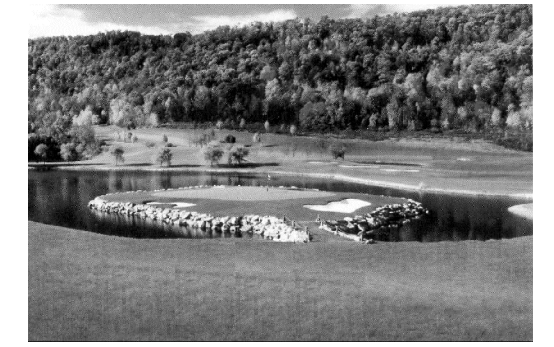

ERNIE ELS DESIGN

1801 NORTH COLUMBIAN AVENUE, SUITE 110
WILMINGTON, DELAWARE 19804

ROBERT A.M. STERN ARCHITECTS

100 WEST 17TH STREET
NEW YORK, NY 10011
PHONE: (212) 213-2000

THE Chazen COMPANIES

Engineers/Surveyors
Planners
Environmental Scientists

CHAZEN ENGINEERING, LAND SURVEYING & LANDSCAPE ARCHITECTURE CO., P.C.

Dutchess County Office: 21 Van Street, Poughkeepsie, New York 12601
Capital District Office: 516 Madison Avenue, New York, New York 10022
Orange County Office: 120 Oak Street, Greenvale, New York 11548
North County Office: 100 Oak Street, Greenvale, New York 11548

REV.	DATE	REVISION
1	2/7/08	REVISED MAP SUBMISSION
2	02/08	

**SILO RIDGE RESORT COMMUNITY
TRADITIONAL NEIGHBORHOOD ALTERNATIVE**

**OVERALL SITE PLAN
MASTER DEVELOPMENT PLAN**

TOWN OF AMENIA, DUTCHESS COUNTY, NEW YORK

drawn	checked
CJB	FRJ/AR
date	scale
12/7/07	1"=200'
project no.	
10454.02	
sheet no.	
SP2	
3 OF 17	